

AIRPORT DIAGRAM

AL-5490 (FAA)

SACRAMENTO INTL (SMF)
SACRAMENTO, CALIFORNIA

D-ATIS
126.75
CAPITOL TOWER
125.7 256.7
GND CON
121.7 256.7
CLNC DEL
121.1 256.7
CPDLC
PDC



HIRL all rws
TDZL/RCLS Rws 17L and 17R

SAID in use. Operate transponders with altitude reporting mode and ADS-B (if equipped) enabled on all airport surfaces.

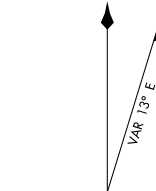

JANUARY 2020
ANNUAL RATE OF CHANGE
0.1° W

*DENOTES DE-ICING AREA

SW-2, 11 JUN 2026 to 09 JUL 2026

SW-2, 11 JUN 2026 to 09 JUL 2026

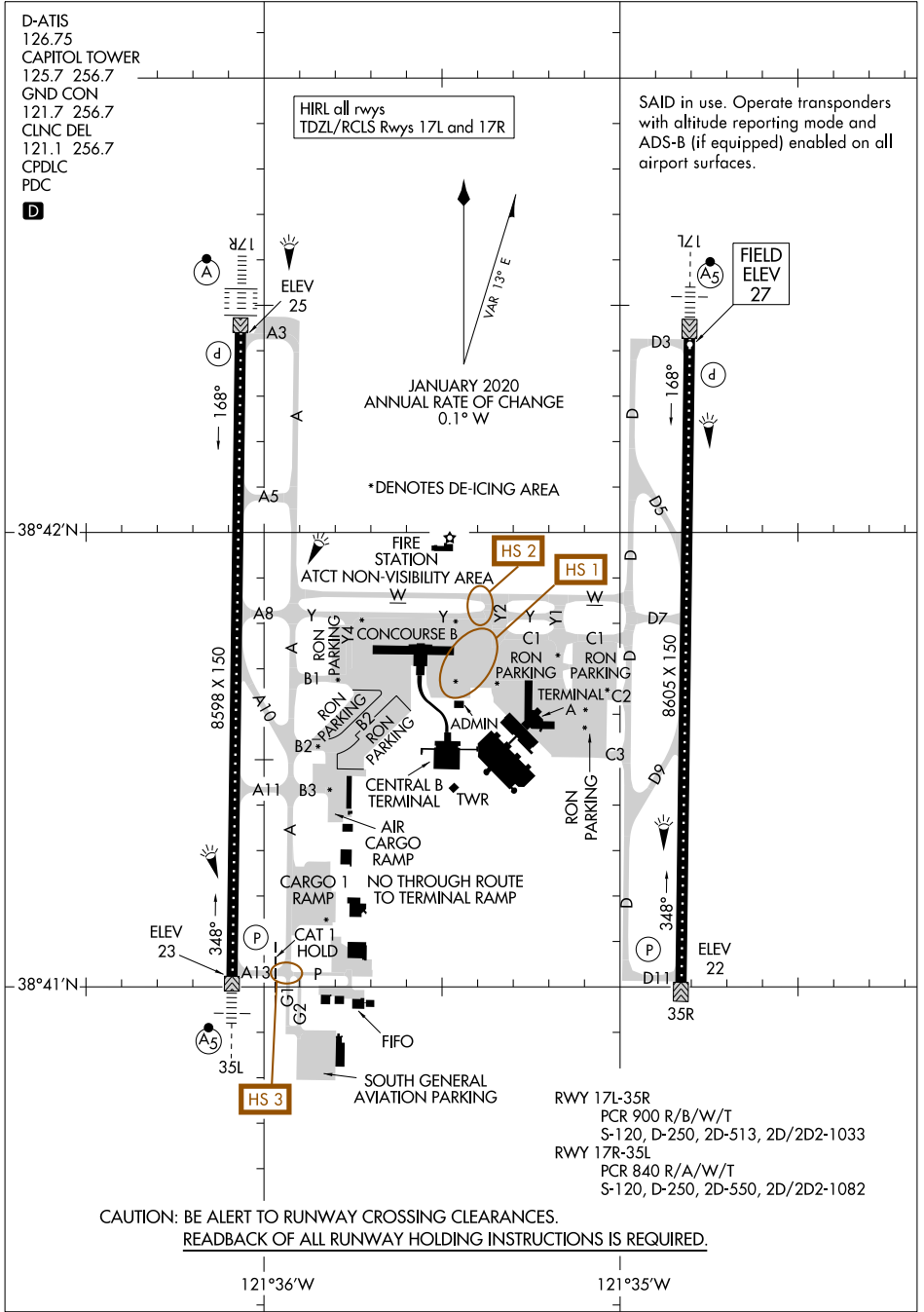

RWY 17L-35R
PCR 900 R/B/W/T
S-120, D-250, 2D-513, 2D/2D2-1033
RWY 17R-35L
PCR 840 R/A/W/T
S-120, D-250, 2D-550, 2D/2D2-1082

CAUTION: BE ALERT TO RUNWAY CROSSING CLEARANCES.
READBACK OF ALL RUNWAY HOLDING INSTRUCTIONS IS REQUIRED.

AIRPORT DIAGRAM

SACRAMENTO, CALIFORNIA
SACRAMENTO INTL (SMF)