

# AIRPORT DIAGRAM

LYNCHBURG RGNL/PRESTON GLENN FLD (LYH)  
AL-499 (FAA) LYNCHBURG, VIRGINIA

ATIS  
119.8  
LYNCHBURG TOWER ★  
127.65 (CTAF) ●  
257.8  
GND CON  
121.9

CAUTION: BE ALERT TO RUNWAY CROSSING CLEARANCES.  
READBACK OF ALL RUNWAY HOLDING INSTRUCTIONS IS REQUIRED.

**D**

37°20.0'N

37°19.5'N

37°19.0'N

79°12.5'W

79°12.0'W

79°11.5'W

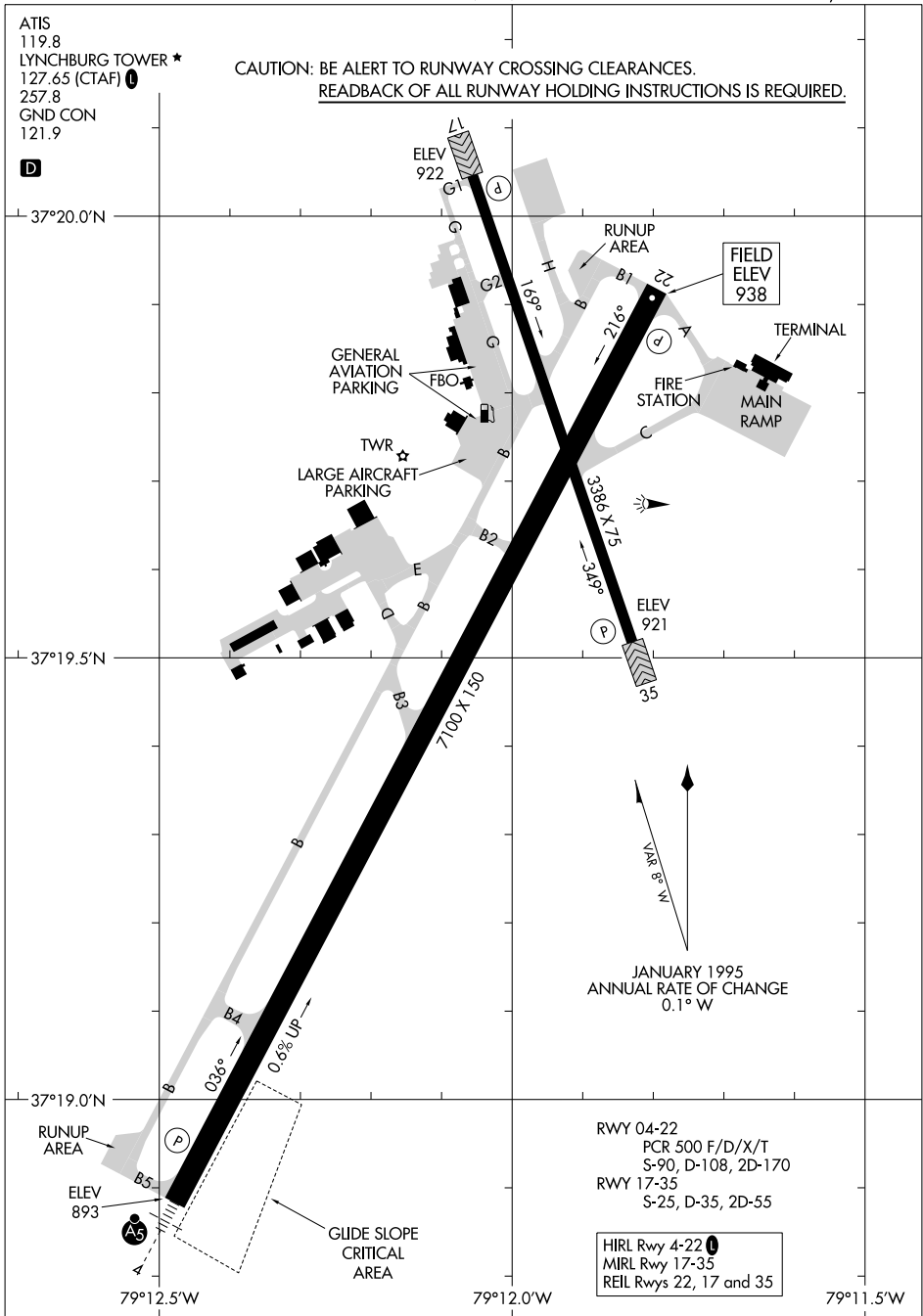

JANUARY 1995  
ANNUAL RATE OF CHANGE  
0.1° W

RWY 04-22  
PCR 500 F/D/X/T  
S-90, D-108, 2D-170  
RWY 17-35  
S-25, D-35, 2D-55

HIRL Rwy 4-22 ●  
MIRL Rwy 17-35  
REIL Rws 22, 17 and 35

# AIRPORT DIAGRAM

LYNCHBURG, VIRGINIA  
LYNCHBURG RGNL/PRESTON GLENN FLD (LYH)

NE-3, 11 JUN 2026 to 09 JUL 2026

NE-3, 11 JUN 2026 to 09 JUL 2026